



PSC Hand Safety
India Pvt. Limited

The Paradigm Shift to Hands-Free Safety

Moving beyond PPE to true Engineering
Controls in heavy industry.

PSC Hand Safety India Pvt. Ltd. - Because Every Hand Matters



50%+

of all workplace
injuries involve hands.

75%+

of hand injuries are
preventable with
engineering controls.

85%

reduction in hand injuries
reported with no-touch
tools in operation.

The Anatomy of a Hand Injury



PSC Hand Safety
India Pvt. Limited

The most common—and preventable—incidents occur in four primary danger zones.

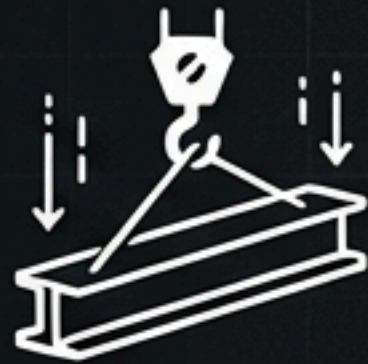

Suspended Loads:
Guiding swinging crane
picks and taglines.



Strike Zones:
Flange bolting and hammer
union operations.

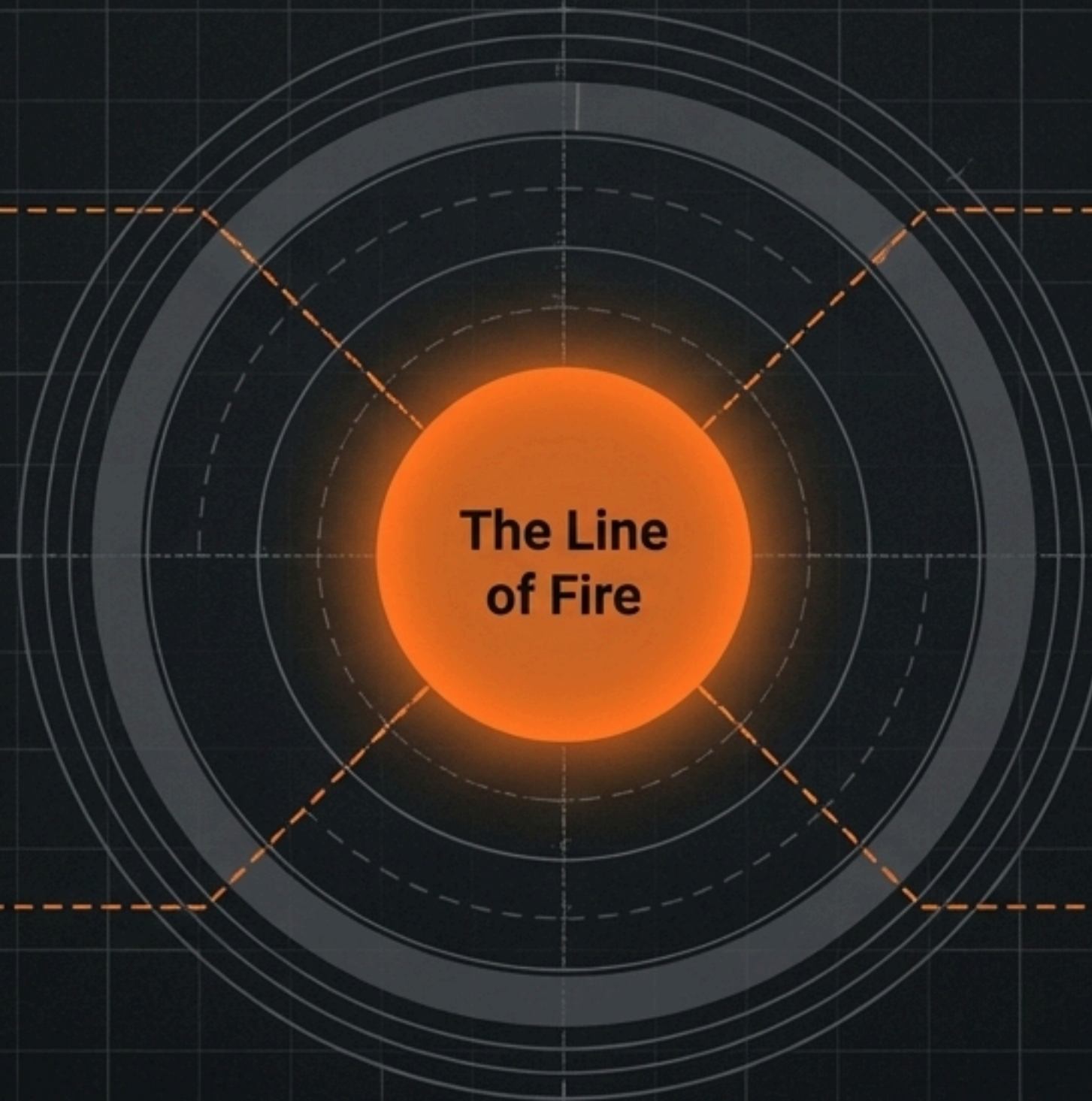

Pinch Points:
Positioning steel, pipes,
and heavy components.



Rotating Equipment:
Drill pipe stabbing and
rotary table areas.

The 1-Second Mistake

Why do workers bypass safety protocols?



PSC Hand Safety
India Pvt. Limited

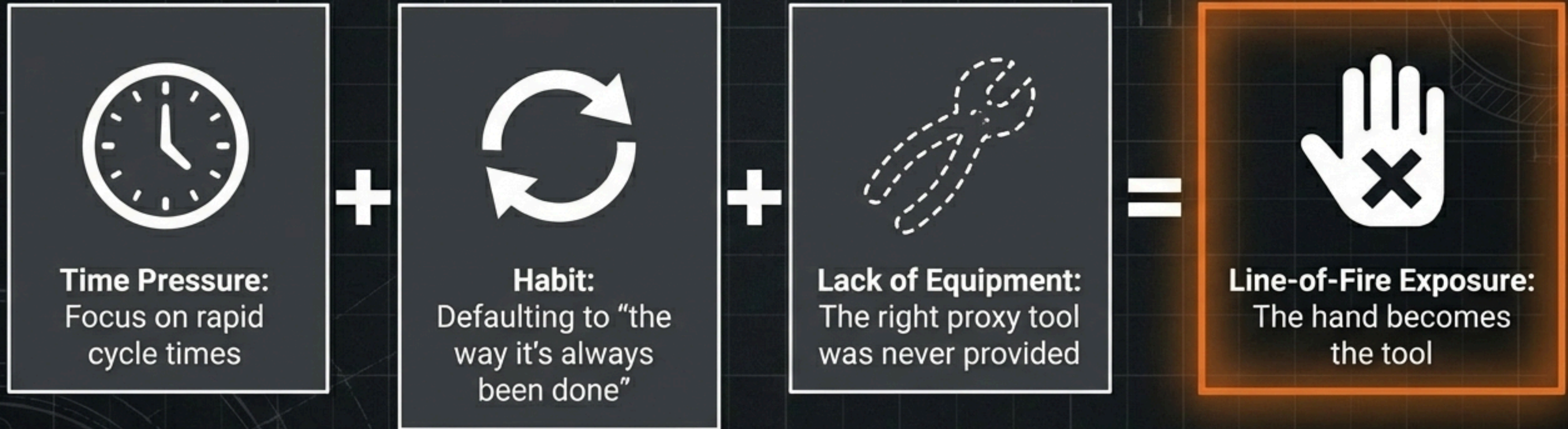



The PPE Fallacy

Gloves are the last line of defense, not the solution. They do not stop crushing force.

Gloves are the last line of defense, not the solution. They do not stop crushing force.

OSHA and ISO 45001 mandate prioritizing **Engineering Controls** over PPE.

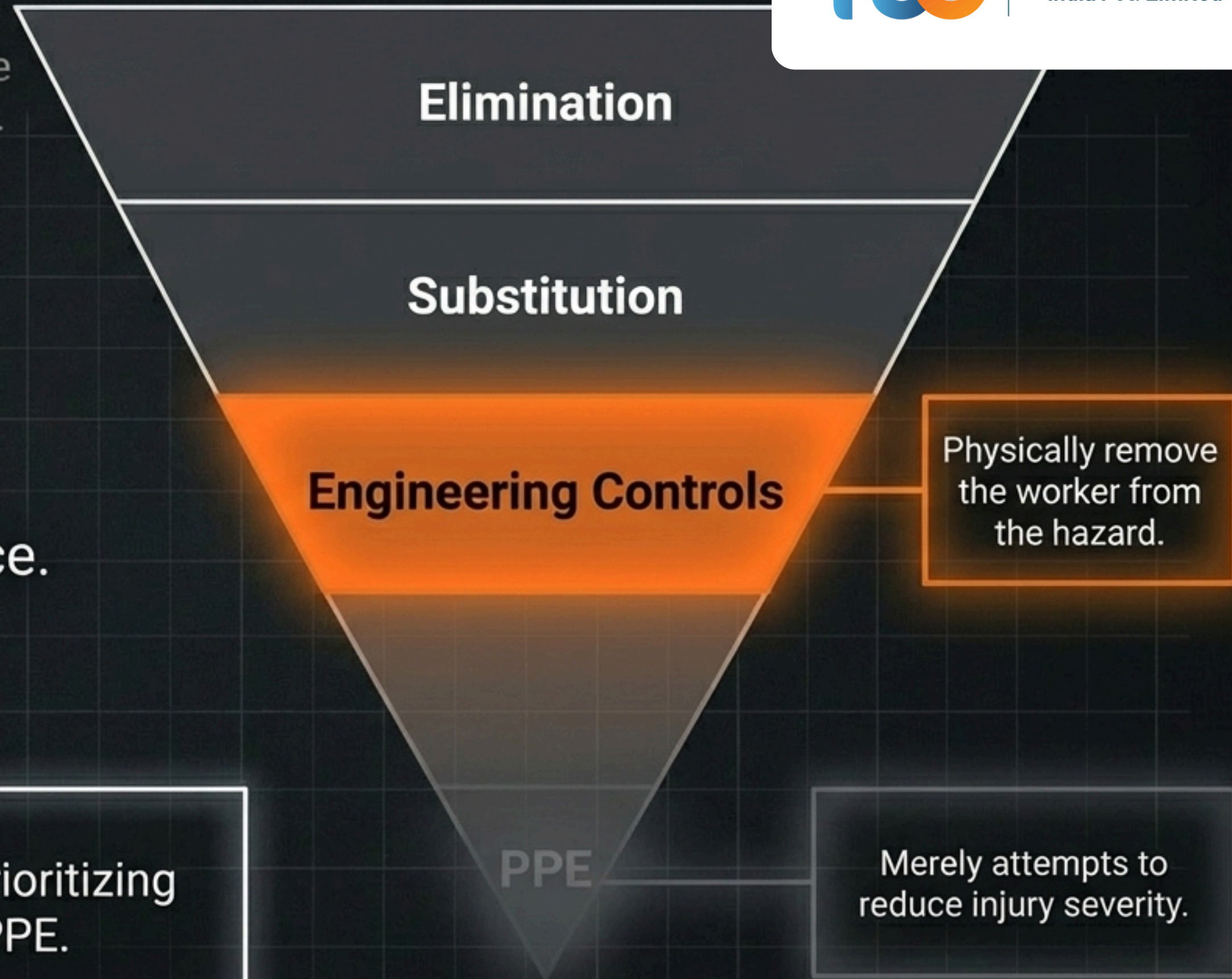

Elimination

Substitution

Engineering Controls

PPE

Physically remove the worker from the hazard.

Merely attempts to reduce injury severity.

Conventional Does Not Mean Safe

Diagnosing the flaw in everyday operational practices.



PSC Hand Safety
India Pvt. Limited

Hazard	Conventional (Unsafe) Practice	Resulting Risk
Suspended load guidance	Bare hands on rope/load	Crush & snag exposure
Drill pipe stabbing	Manual hand-guiding	Pinch point & rotational risk
Steel load positioning	Hands near pinch points	High-impact crush risk
Flange bolt operations	Fingers near hammer strike	Struck-by lacerations & fractures



**“If hands are part of the task —
the task needs to change.”**

No-Touch operation is the modern standard of care.
Hands-free tools are engineering controls, not optional extras.

The Engineering Control Mechanism

Replacing the human hand with a structural proxy.



PSC Hand Safety
India Pvt. Limited

Status Quo



Step 1: Line of Fire
(Direct Contact)

The Solution



Step 2 & 3: Tool intercepts the hazard.
Safe Working Distance achieved (Zero-Contact).



PSC Hand Safety
India Pvt. Limited

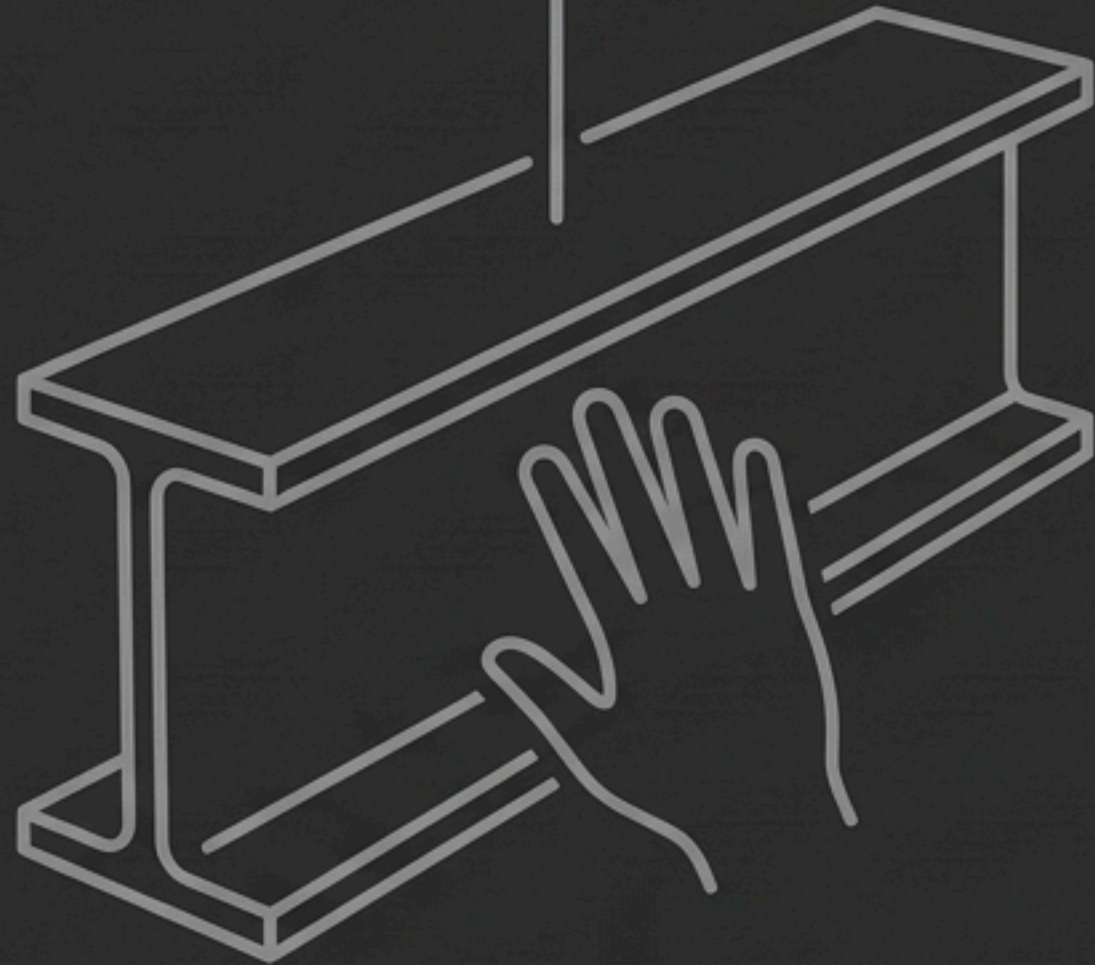

**Point of Contact:
The Worker.**

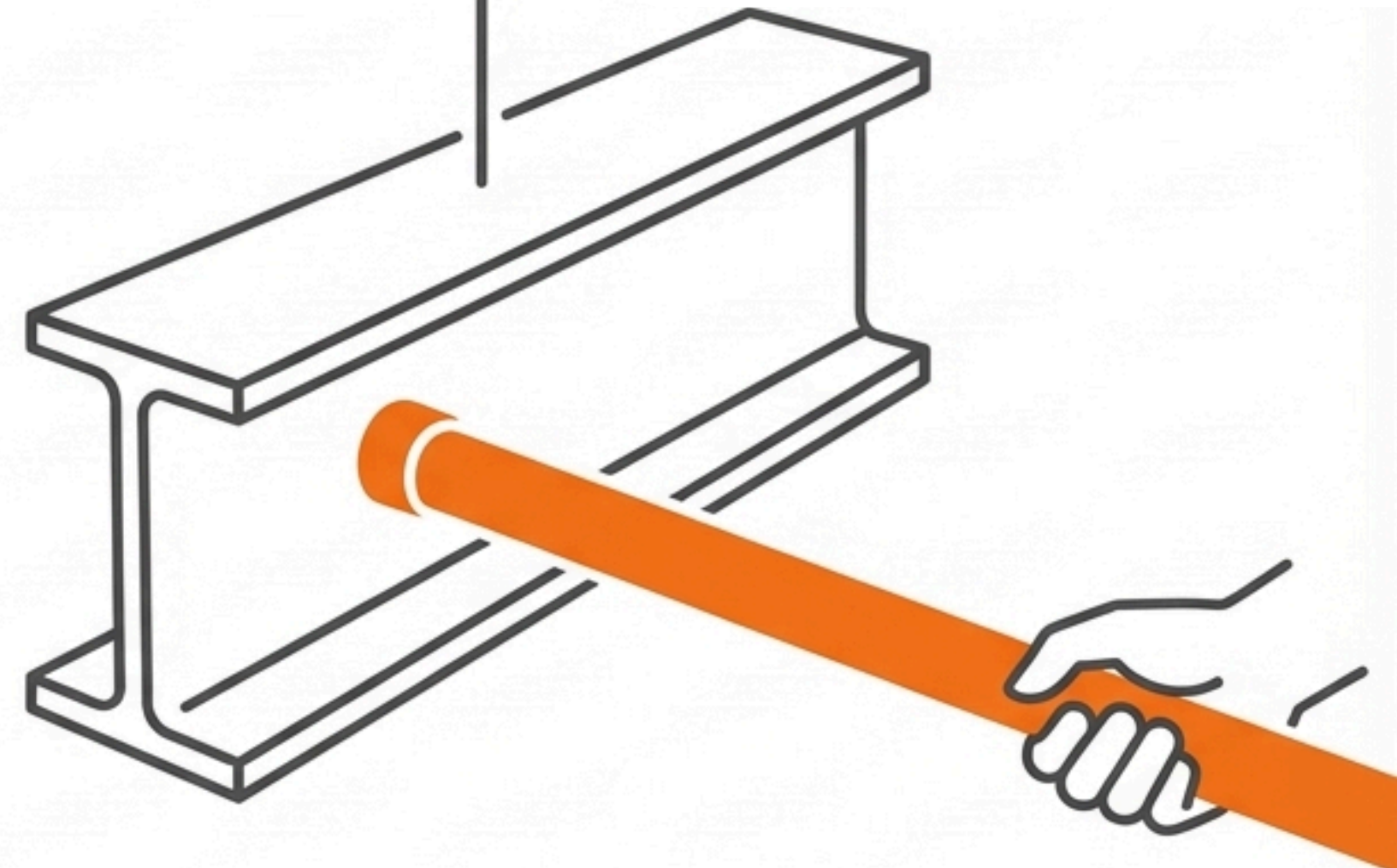

**Point of Contact:
The Tool.**

Shifting from injury mitigation to hazard elimination.

A Comprehensive Zero-Contact Portfolio



PSC Hand Safety
India Pvt. Limited



Distance Creation

Rigid push/pull poles and tubular guiders for suspended loads and drilling.



Magnetic Control

Switchable magnetic positioning tools for handling sharp, hot, or heavy steel safely.



Strike Isolation

Hands-off wrench grabs and punch holders keeping fingers away from impact zones.



Anti-Tangle Rigging

Rigid-core taglines that eliminate the swivels and snags of improvised ropes.



Universal Heavy Industry Application

Proven engineering controls across all high-risk environments.



Oil & Gas Rigs



Steel Mills



Power Generation



Construction



Manufacturing



Mining



Automotive Assembly



Aerospace



The Operational Return on Safety



Regulatory Compliance: Instantly aligns operations with OSHA mandates and ISO 45001 requirements for hazard elimination.



Efficiency & Workflow: Ergonomic, purpose-built tools speed up cycle times without the hesitation caused by proximity to danger.



The Ultimate Metric: Drives facilities toward a true 'Zero-Incident' culture by making hand crush and strike injuries physically impossible.



PSC Hand Safety
India Pvt. Limited

Zero-Contact. Total Control.

Deploy the standard of care to your facility today.

PSC Hand Safety India Pvt. Ltd.

Web: www.pschandsfree.com

Email: info@projectsalescorp.com

Phone: +91 9100932334